

Sequoia Elementary School

3730 Lincoln Avenue

Site 151 Region 1 Grades K-5

"Sequoia Elementary School sits in the heart of Oakland's foothills. A fine model of an urban learning community, Sequoia reflects a richly diverse community in all ways: cultural, ethnic, and socioeconomic." - Sequoia Elementary School website

The site is located in the Dimond District on Lincoln Avenue, three blocks from Dimond Park to the east, and a short ways from the Dimond commercial district down the hill, consisting of two grocery stores, a public library, frequent public transportation, and numerous small businesses and shops.

PROGRAMMING (2012-2013)

Schools / Enrollment

	SDC	Non-SDC	Total	API (2010-2011)
Sequoia	12	413	425	812

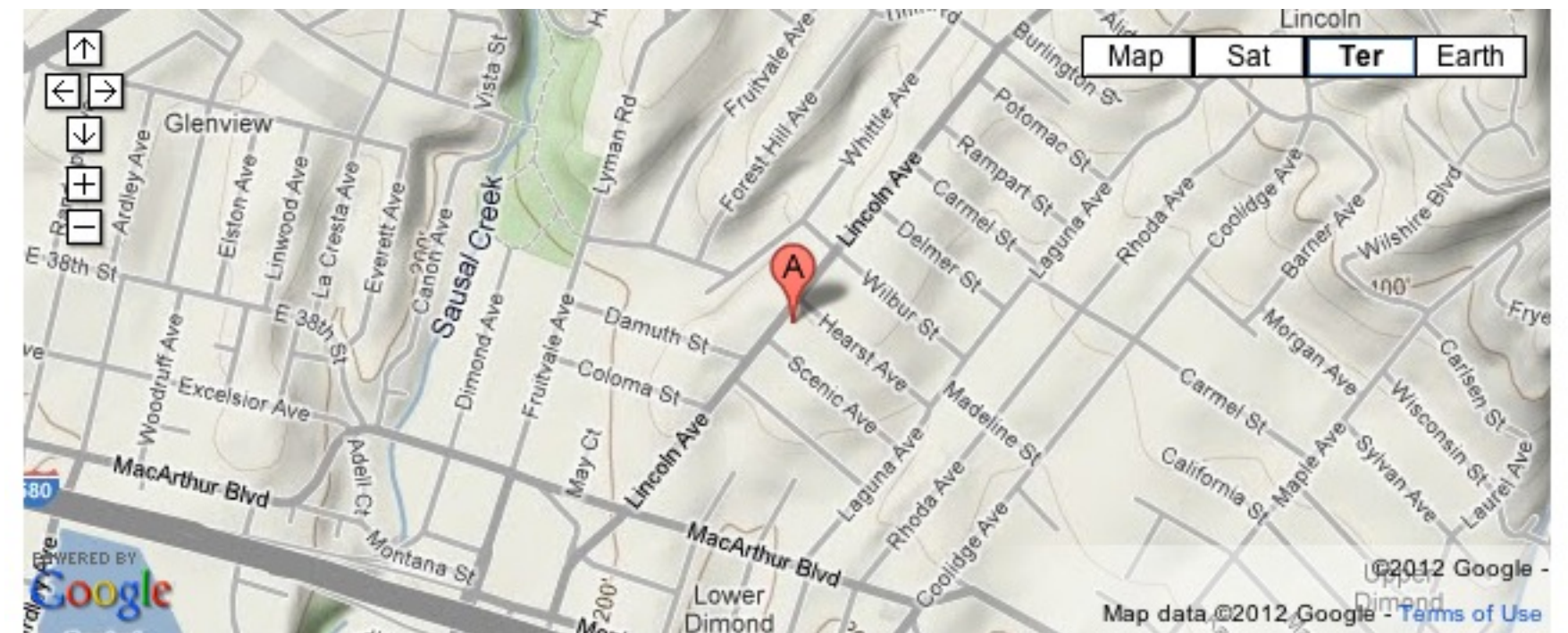

FACILITIES (Summer 2012)

LEARNING ENVIRONMENTS
LIBRARY
MULTI-PURPOSE
SCHOOL OFFICE & WORKSPACE

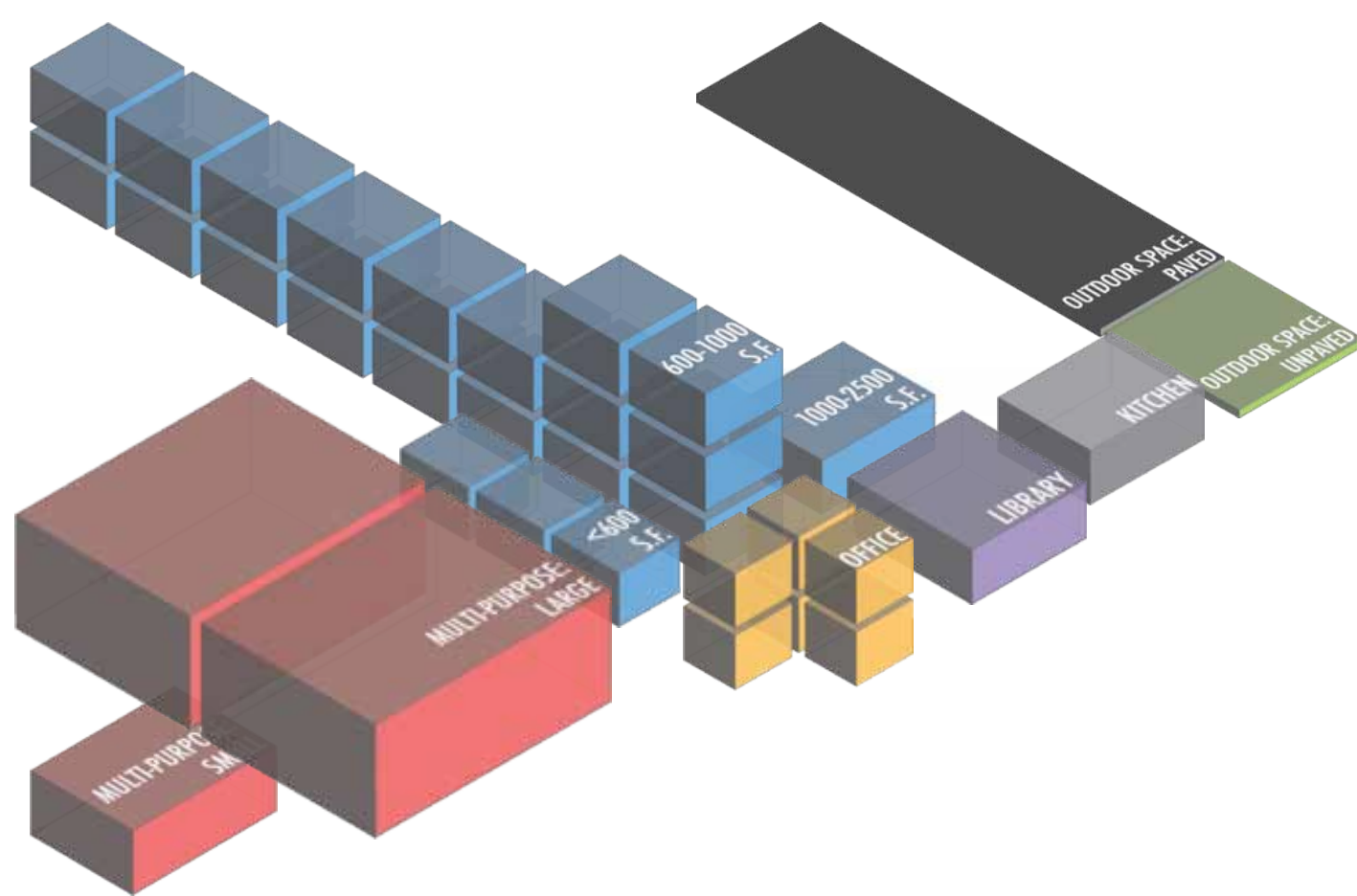

Summary Counts

	Total	Permanent	Portable
Site Acreage	2.6		
Building Footprint (sf)	25,640		
Building Area (sf)	39,669	37,845	1,824
Classroom-Sized Rooms	19	17	2
<i>3 rooms < 600 s.f. used as classrooms</i>			
	Number of Rooms		Sq Ft
Library Rooms	1		736
Auditorium/Cafeteria/ Multi-purpose/Gym	3		6,937
Admin/Office/ Conference Room	6		1,776
School Gardens	Number: 1		Sq Ft: 400
Kitchen	Type: Finishing		
On-site Health Clinic	No		

SITE SUMMARY (Summer 2012)

Sports / Recreation

- Play structure ●●
- Basketball hoops ●●●●●●●●
- Swimming pool
- Soccer/football field
- Volleyball court
- Track
- Baseball field
- Tennis court

Qualitative Assessment

Transit Accommodations

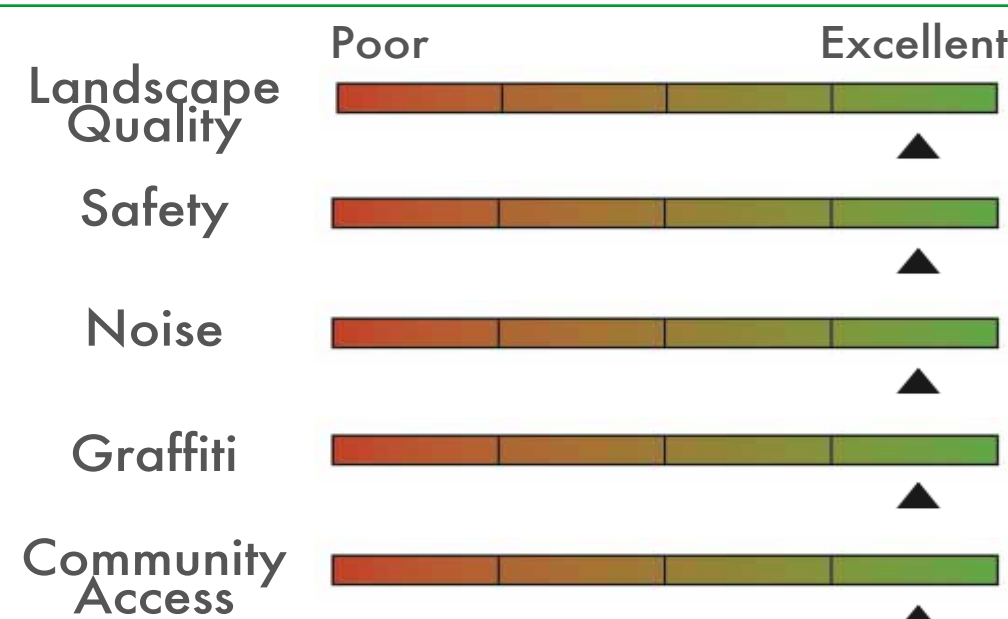

Open Space

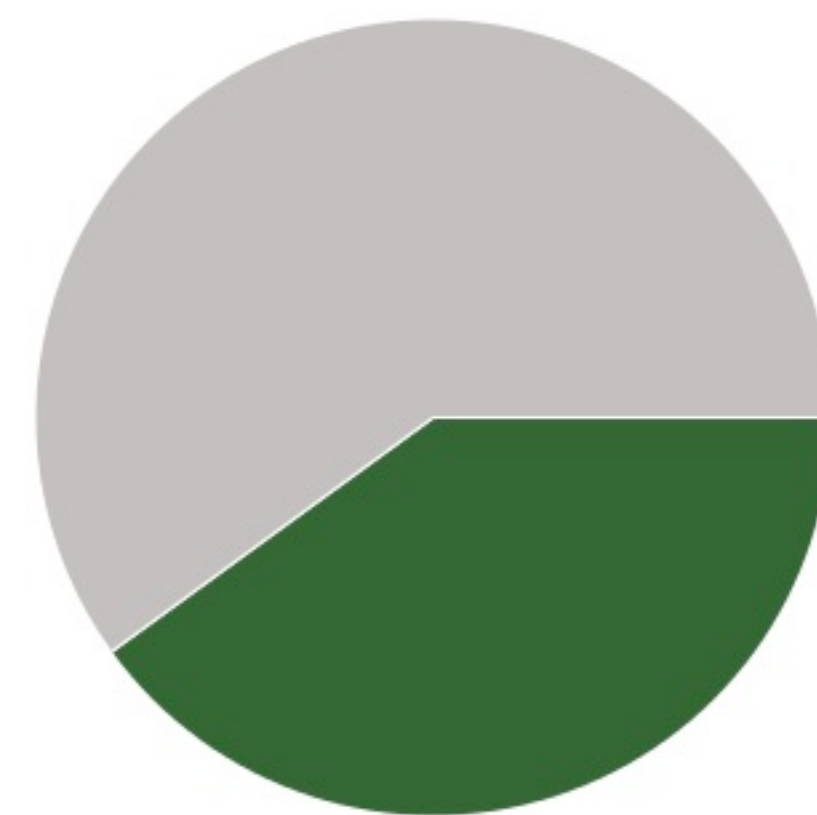

Paved 60% 40% Green

Sequoia Elementary School

Building Records

Site ID 151

Region 1

Grades K-5

Site & Facilities Photos - Summer 2011 (Sample)

*To view the full set, visit: <http://bitly.com/vWp7WP>



BUILDING A		BUILDING AREA (SQFT): 8,568		CONSTRUCTED: 1958	
STRUCTURAL ELEMENTS		ROOFING Plywood on joists	FOUNDATION Strip footings (under structural walls)	VERTICAL RESISTANCE Wood stud walls	
QUALITATIVE BUILDING ASSESSMENT		EXTERIOR Physical Condition: Excellent Circulation & Wayfinding: Excellent		INTERIOR Physical Condition: Excellent Circulation & Wayfinding: Excellent	
ROOM SUMMARY		NO. OF CLASSROOMS 6	NO. OF OFFICES 1	NO. OF ADMIN ROOMS 5	NO. OF RESTROOMS 5
		NO. OF STUDENT COMPUTERS 14	NO. OF ADMIN WORKSTATIONS 1	ADDITIONAL ADMIN SPACES	

BUILDING B		BUILDING AREA (SQFT): 5,002		CONSTRUCTED: 1958	
STRUCTURAL ELEMENTS		ROOFING Plywood on wood joists and steel beams	FOUNDATION Strip footings (under structural walls)	VERTICAL RESISTANCE Wood stud walls (lower portion)/ gypsum board (upper portion); Rigid frames - Steel moment frames	
QUALITATIVE BUILDING ASSESSMENT		EXTERIOR Physical Condition: Excellent Circulation & Wayfinding: Excellent		INTERIOR Physical Condition: Excellent Circulation & Wayfinding: Excellent	
ROOM SUMMARY		NO. OF CLASSROOMS 1	NO. OF OFFICES 4	NO. OF ADMIN ROOMS 1	NO. OF RESTROOMS 1
		NO. OF STUDENT COMPUTERS	NO. OF ADMIN WORKSTATIONS	ADDITIONAL ADMIN SPACES Teachers' Lounge	

BUILDING C		BUILDING AREA (SQFT): 24,275		CONSTRUCTED: 1936	
STRUCTURAL ELEMENTS		ROOFING Steel deck on steel trusses	FOUNDATION Strip footings (under structural walls); pier footings (under exterior elevator shaft)	VERTICAL RESISTANCE Shear wall - Concrete shear walls; Rigid frames - Steel moment frames	
QUALITATIVE BUILDING ASSESSMENT		EXTERIOR Physical Condition: Excellent Circulation & Wayfinding: Excellent		INTERIOR Physical Condition: Excellent Circulation & Wayfinding: Excellent	
ROOM SUMMARY		NO. OF CLASSROOMS 11	NO. OF OFFICES 4	NO. OF ADMIN ROOMS 5	NO. OF RESTROOMS 6
		NO. OF STUDENT COMPUTERS 59	NO. OF ADMIN WORKSTATIONS 6	ADDITIONAL ADMIN SPACES	

Sequoia Elementary School

Portable Records

Site ID 151

Region 1

Grades K-5

P1	Manufactured: 1999	<u>NO. OF CLASSROOMS</u> 1	<u>NO. OF ADMIN ROOMS</u>
P2	Manufactured: 2001	<u>NO. OF CLASSROOMS</u> 1	<u>NO. OF ADMIN ROOMS</u>

Portable Inventory

Total Count
2

Average Age
12 Years

Qualitative Conditions Assessment

	Poor	Excellent
EXT.		
INT.		

Sequoia Elementary School

Rooms Summary & List

Site ID 151

Region 1

Grades K-5

	BLDG LEVEL	ROOM #	ROOM USE	ROOM AREA (SQUARE FOOTAGE)	CLASSROOM COMPUTERS	ADMIN WORKSTATIONS	MARKED ROOM #	ROOM CAPACITY
BUILDING								
		A						
	1	1	Classroom	912	2		10	
	1	2	Classroom	907	2		9	
	1	3	Classroom	907	4		8	
	1	4	Classroom	912			5	
	1	5	Classroom	907	2			
	1	6	Classroom	1,108	4		7	
	1	7	Restroom	63				
	1	8	Restroom	63				
	1	9	Storage	127		1	9	
	1	10	Restroom	198				
	1	11	Restroom	206				
	1	12	Building Utilities	56			12	
	1	13	Restroom	111				
	1	14	Building Utilities	130				
	1	15	Storage	70				
	1	16	Storage	28				
	1	17	Circulation	1,269				
	1	18	Circulation	37				
	1	19	Circulation	47				
	2	1	Building Utilities	510			10	
BUILDING								
		B						
	1	1	Admin/Office	356		2	13	
	1	2	Lounge/Staff Dining	428		2	14	
	1	3	Building Utilities	693			15	
	1	4	Storage	38				
	1	5	Building Utilities	13				
	1	6	Restroom	59				
	1	7	Storage	12			18	
	1	8	Building Utilities	91				
	1	9	Storage	153			17	
	1	10	Cafeteria	3,159				
BUILDING								
		C						
	1	2	Storage	33			18	
	1	3	Classroom	702	1		18	
	1	4	Classroom	702	1		17	
	1	5	Storage	33			17	
	1	6	Storage	83				
	1	7	Library	736			16	
	1	8	Classroom	529	1			
	1	9	Admin/Office	437			16	
	1	10	Admin/Office	475		2	15	
	1	11	Classroom	173			15	
	1	12	Admin/Office	224		1		
	1	13	Building Utilities	28				
	1	14	Restroom	130			14	
	1	15	Multipurpose	3,105			14	
	1	16	Storage	68				
	1	17	Circulation	70				
	1	18	Circulation	193			218	
	1	19	Restroom	525			219	
	1	20	Restroom	120			220	
	1	21	Classroom	130			221	
	1	22	Admin/Office	130		1	222	
	1	23	Building Utilities	84		1	23	

BLDG LEVEL	ROOM #	ROOM USE	ROOM AREA (SQUARE FOOTAGE)	CLASSROOM COMPUTERS	ADMIN WORKSTATIONS	MARKED ROOM #	ROOM CAPACITY
1	24	Building Utilities	143			24	
1	25	Storage	65			25	
1	26	Storage	120				
1	27	Classroom	750	29		13	
1	28	Storage	125			12	
1	29	Restroom	388				
1	30	Circulation	70				
1	31	Circulation	193				
1	32	Circulation	2,064				
1	33	Storage	40			11	
1	34	Storage	64				
1	35	Storage	40				
1	36	Storage	88				
1	37	Circulation	40			38	
1	38	Multipurpose	673				
2	1	Storage	83				
2	2	Storage	33			18	
2	3	Classroom	702	4		18	
2	4	Classroom	702			17	
2	5	Storage	33			17	
2	6	Storage	83				
2	7	Classroom	736	4		16	
2	8	Storage	83				
2	9	Storage	33			16	
2	10	Classroom	736	6		15	
2	11	Storage	33			15	
2	12	Storage	83				
2	13	Storage	126				
2	14	Storage	30			14	
2	15	Classroom	824	4		14	
2	16	Restroom	130				
2	17	Restroom	176				
2	18	Storage	36			218	
2	19	Admin/Office	154		1	219	
2	20	Storage	36			220	
2	21	Storage	146			221	
2	22	Storage	23			222	
2	24	Circulation	263			24	
2	25	Storage	75			25	
2	26	Storage	25				
2	27	Classroom	750	4		13	
2	28	Classroom	763	1		12	
2	29	Storage	33				
2	30	Storage	93				
2	31	Storage	33				
2	32	Storage	93				
2	33	Classroom	800	5		11	
2	34	Circulation	263				
2	35	Circulation	1,540				
2	36	Building Utilities					
3	1	Building Utilities	625				
3	2	Storage	325			18	
PORTABLE	P1						
		1	Classroom	912	3		
PORTABLE	P2						
		1	Classroom	912			