

Thornhill Elementary School

5880 Thornhill Drive

Site 157 Region 1 Grades K-5

"Thornhill Elementary School was built in 1958 and is located in the North Oakland hills area. The school is located in a low-density neighborhood with many trees, giving it a park-like setting. Nearby is the Montclair business district." - Thornhill Elementary School website

PROGRAMMING (2012-2013)

Schools / Enrollment

	SDC	Non-SDC	Total	API (2010-2011)
Thornhill	8	400	408	954

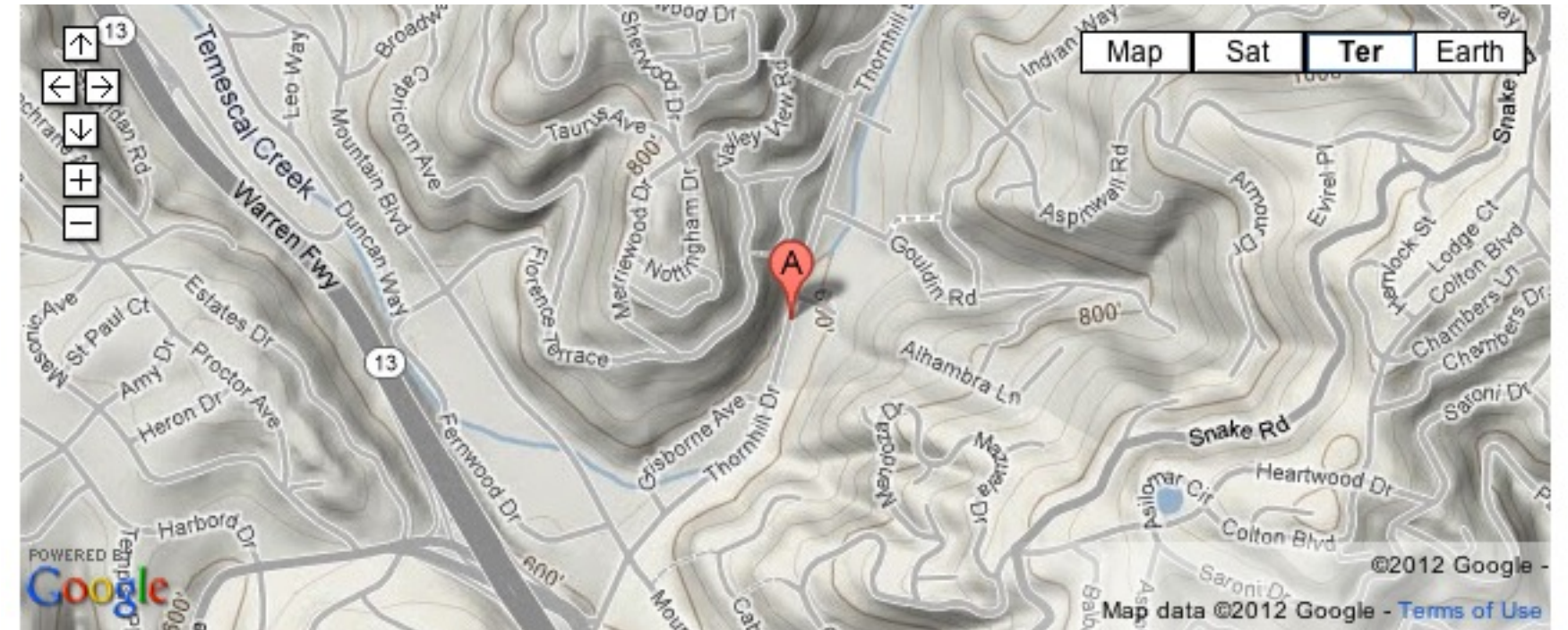

FACILITIES (Summer 2012)

LEARNING ENVIRONMENTS

LIBRARY

MULTI-PURPOSE

SCHOOL OFFICE & WORKSPACE

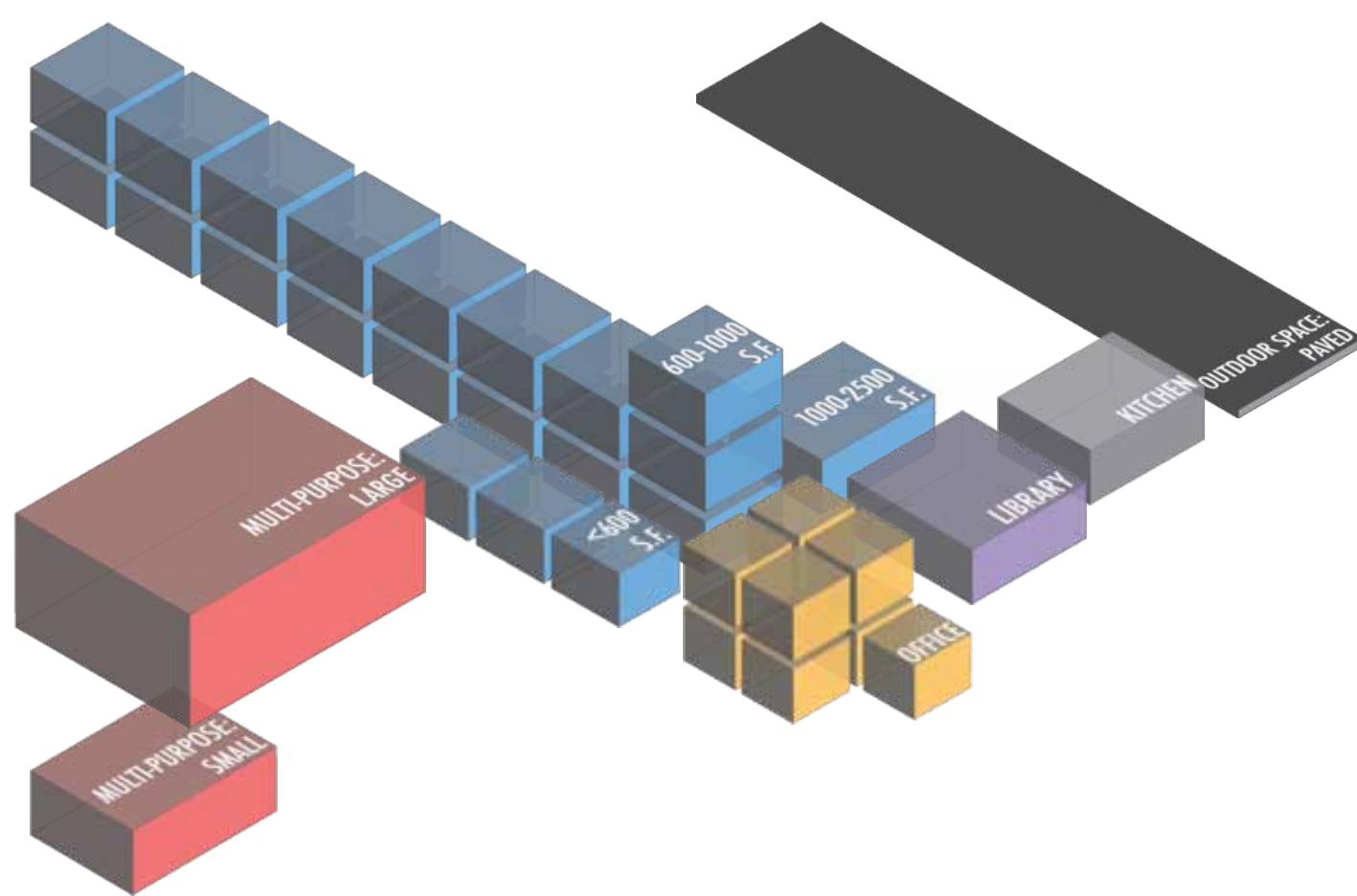

Summary Counts

	Total	Permanent	Portable
Site Acreage	4.0		
Building Footprint (sf)	33,796		
Building Area (sf)	32,872	27,552	5,320
Classroom-Sized Rooms	18	12	6
<i>3 rooms < 600 s.f. used as classrooms</i>			
	Number of Rooms		Sq Ft
Library Rooms	1		900
Auditorium/Cafeteria/ Multi-purpose/Gym	2		3,840
Admin/Office/ Conference Room	9		1,682
School Gardens	Number: 1		Sq Ft: 400
Kitchen	Type: Finishing		
On-site Health Clinic	No		

SITE SUMMARY (Summer 2012)

Sports / Recreation

- Play structure ●
- Basketball hoops ●●●●
- Swimming pool
- Soccer/football field
- Volleyball court
- Track
- Baseball field
- Tennis court

Qualitative Assessment

Transit Accommodations



7

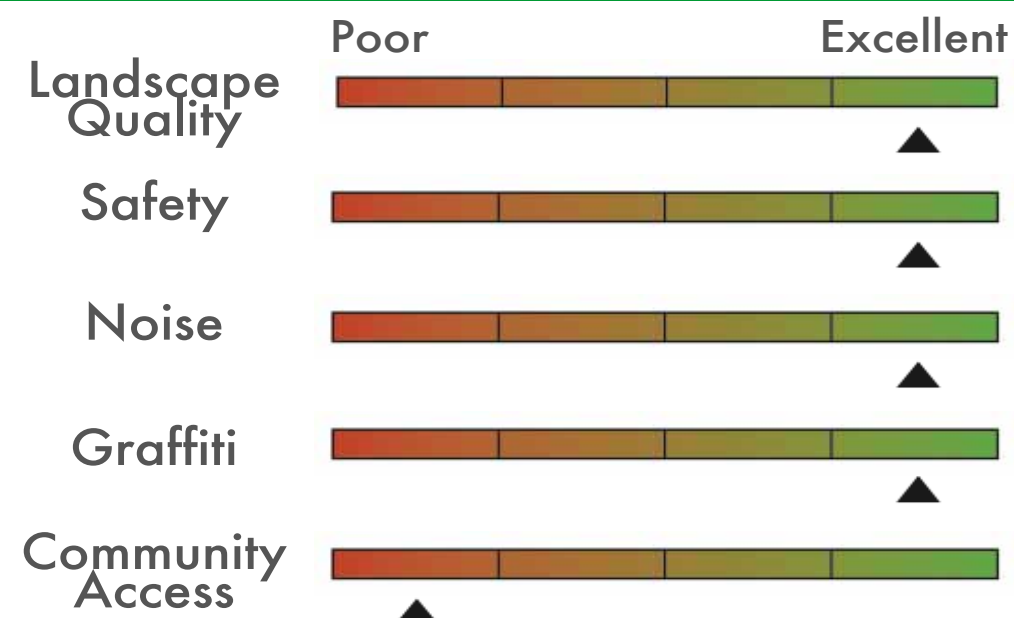

Open Space

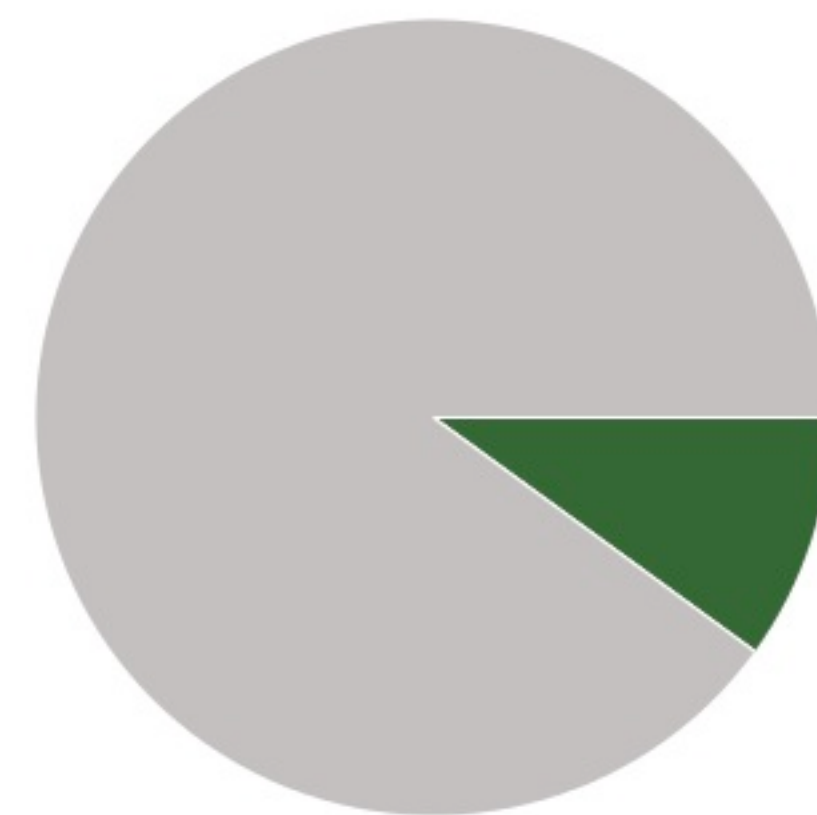

Paved 90% 10% Green

Thornhill Elementary School

Building Records

Site ID 157

Region 1

Grades K-5

Site & Facilities Photos - Summer 2011 (Sample)

*To view the full set, visit: <http://bitly.com/vW418U>

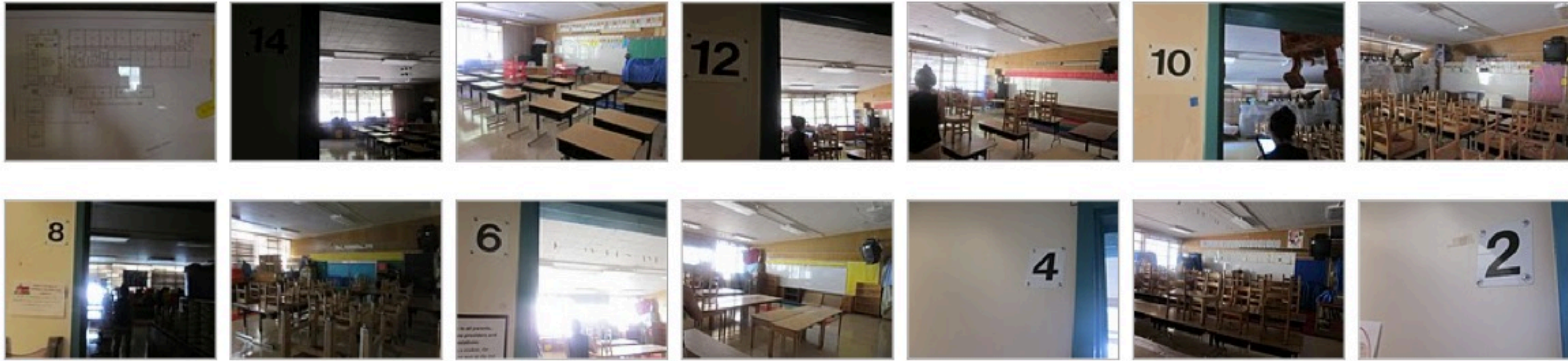

BUILDING A		BUILDING AREA (SQFT): 17,478		CONSTRUCTED: 1958	
STRUCTURAL ELEMENTS		ROOFING Plywood on wood joists	FOUNDATION Spread footings (under interior columns); strip footings (under structural walls); pier footings (under columns)	VERTICAL RESISTANCE Wood stud walls	
QUALITATIVE BUILDING ASSESSMENT		EXTERIOR		INTERIOR	
		Physical Condition: [Progress bar from Poor to Excellent, marker at ~80%]	Circulation & Wayfinding: [Progress bar from Poor to Excellent, marker at ~80%]	Physical Condition: [Progress bar from Poor to Excellent, marker at ~80%]	Circulation & Wayfinding: [Progress bar from Poor to Excellent, marker at ~80%]
ROOM SUMMARY		NO. OF CLASSROOMS 11	NO. OF OFFICES 7	NO. OF ADMIN ROOMS 9	NO. OF RESTROOMS 6
		NO. OF STUDENT COMPUTERS 11	NO. OF ADMIN WORKSTATIONS 8	ADDITIONAL ADMIN SPACES	

BUILDING B		BUILDING AREA (SQFT): 8,978		CONSTRUCTED: 1958	
STRUCTURAL ELEMENTS		ROOFING Plywood on wood joists	FOUNDATION Strip footings (under structural walls)	VERTICAL RESISTANCE Wood stud walls	
QUALITATIVE BUILDING ASSESSMENT		EXTERIOR		INTERIOR	
		Physical Condition: [Progress bar from Poor to Excellent, marker at ~80%]	Circulation & Wayfinding: [Progress bar from Poor to Excellent, marker at ~80%]	Physical Condition: [Progress bar from Poor to Excellent, marker at ~80%]	Circulation & Wayfinding: [Progress bar from Poor to Excellent, marker at ~80%]
ROOM SUMMARY		NO. OF CLASSROOMS	NO. OF OFFICES	NO. OF ADMIN ROOMS	NO. OF RESTROOMS 4
		NO. OF STUDENT COMPUTERS	NO. OF ADMIN WORKSTATIONS 1	ADDITIONAL ADMIN SPACES Teachers' Lounge	

BUILDING C		BUILDING AREA (SQFT): 1,096			
QUALITATIVE BUILDING ASSESSMENT		EXTERIOR		INTERIOR	
		Physical Condition: [Progress bar from Poor to Excellent, marker at ~60%]	Circulation & Wayfinding: [Progress bar from Poor to Excellent, marker at ~80%]	Physical Condition: [Progress bar from Poor to Excellent, marker at ~60%]	Circulation & Wayfinding: [Progress bar from Poor to Excellent, marker at ~80%]
ROOM SUMMARY		NO. OF CLASSROOMS 1	NO. OF OFFICES	NO. OF ADMIN ROOMS	NO. OF RESTROOMS 1
		NO. OF STUDENT COMPUTERS	NO. OF ADMIN WORKSTATIONS	ADDITIONAL ADMIN SPACES	

Thornhill Elementary School

Portable Records

Site ID 157

Region 1

Grades K-5

	Manufactured:	<u>NO. OF CLASSROOMS</u>	<u>NO. OF ADMIN ROOMS</u>
D	1978	1	
P1	2003	1	
P2	2006	1	
P3	2001	1	
P4	1997	1	
P5	1997	1	

Portable Inventory

Total Count
6

Average Age
15 Years

Qualitative Conditions Assessment

Poor Excellent

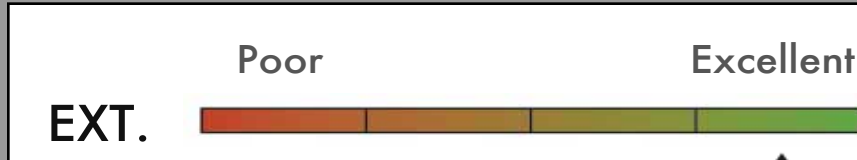
EXT. 

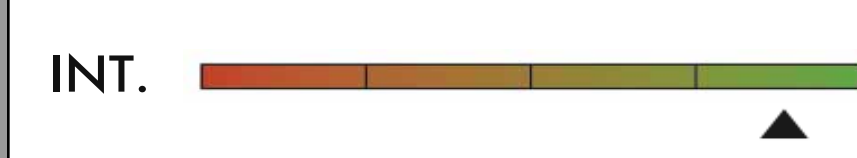
INT. 

Thornhill Elementary School

Rooms Summary & List

Site ID 157

Region 1

Grades K-5

	BLDG LEVEL	ROOM #	ROOM USE	ROOM AREA (SQUARE FOOTAGE)	CLASSROOM COMPUTERS	ADMIN WORKSTATIONS	MARKED ROOM #	ROOM CAPACITY
BUILDING								
		A						
	0	1	Classroom	900	1			
	0	2	Classroom	900	2			
	0	3	Classroom	900				
	0	4	Classroom	900				
	0	5	Classroom	900				
	0	6	Classroom	900	3		8	
	0	7	Classroom	900			10	
	0	8	Classroom	900			12	
	0	9	Classroom	900	3		14	
	0	10	Admin/Office	120				
	0	11	Storage	15				
	0	12	Storage	15				
	0	13	Admin/Office	192		1		
	0	14	Admin/Office	150		1		
	0	15	Admin/Office	270		2		
	0	16	Admin/Office	480				
	0	17	Admin/Office	100		1		
	0	18	Restroom	110				
	0	19	Restroom	54				
	0	20	Building Utilities	100		1		
	0	21a	Circulation	180				
	0	21	Classroom	192	1			
	0	22	Admin/Office	160		1		
	0	23	Admin/Office	90				
	0	24	Classroom	450				
	0	25	Library	900	3			
	0	26	Circulation	2,400				
	0	27	Restroom	336				
	0	28	Restroom	336				
	0	29	Building Utilities	120				
	0	30	Classroom	900	2		1	
	0	31	Classroom	900			2	
	1	1	Storage	364				
	1	2	Storage	210				
	1	3	Restroom	84				
	1	4	Restroom	30				
	1	5	Admin/Office	120		1		
BUILDING								
		B						
	1	1	Circulation	1,000				
	1	2	Circulation	1,350				
	1	3	Multipurpose	3,160				
	1	4	Building Utilities	120				
	1	5	Circulation	72				
	1	6	Circulation	112				
	1	7	Storage	128				
	1	8	Classroom	288				
	1	9	Storage	42				
	1	10	Storage	32				
	1	11	Circulation	40				
	1	12	Storage	144				
	1	13	Restroom	60				
	1	14	Circulation	120		1		
	1	15	Storage	12				
	1	16	Building Utilities	620				
	1	17	Lounge/Staff Dining	360				

		BLDG LEVEL	ROOM #	ROOM USE	ROOM AREA (SQUARE FOOTAGE)	CLASSROOM COMPUTERS	ADMIN WORKSTATIONS	MARKED ROOM #	ROOM CAPACITY
		1	18	Restroom	36				
		1	19	Building Utilities	36				
		1	20	Storage	15				
		1	21	Storage	15				
		1	22	Restroom	70				
		1	23	Circulation	270				
		1	24	Storage	15				
		1	25	Storage	15				
		1	26	Restroom	70				
		1	27	Building Utilities	96				
		1	28	Multipurpose	680				
BUILDING	C								
		1	1	Classroom	1,024			15	
		1	2	Restroom	48				
		1	3	Storage	24				
PORTABLE	D								
			1	Classroom	720			16	
PORTABLE	P1								
			1	Classroom	920				
PORTABLE	P2								
			1	Classroom	920				
PORTABLE	P3								
			1	Classroom	920			17	
PORTABLE	P4								
			1	Classroom	920			18	
PORTABLE	P5								
			1	Classroom	920	2		19	