

Madison Middle School

400 Capistrano Drive

Site 215 Region 3 Grades 6-8

Madison Middle School is situated in the south-east corner of Oakland within sight of several landmarks including the Oakland Airport, Bayfarm Island, and the Coliseum. Sobrante Park Elementary School and Sobrante Field are adjacent to the middle school, and the immediate area is mostly residential. To the south and west, houses give way abruptly to industrial uses, and to the north-west, 98th borders the neighborhood with a string of high density commercial development.

PROGRAMMING (2012-2013)

Schools / Enrollment

	SDC	Non-SDC	Total	API (2010-2011)
James Madison	13	334	347	722

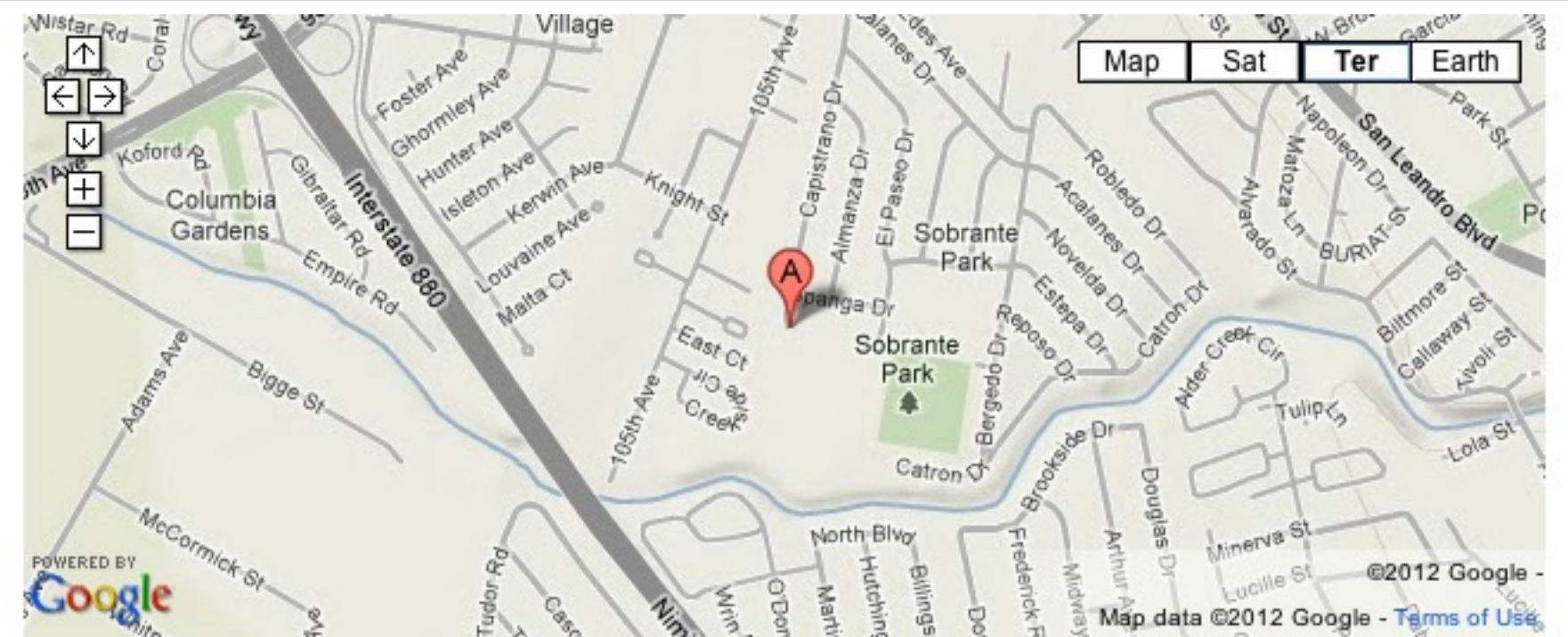

FACILITIES (Summer 2012)

LEARNING ENVIRONMENTS

LIBRARY

MULTI-PURPOSE

SCHOOL OFFICE & WORKSPACE

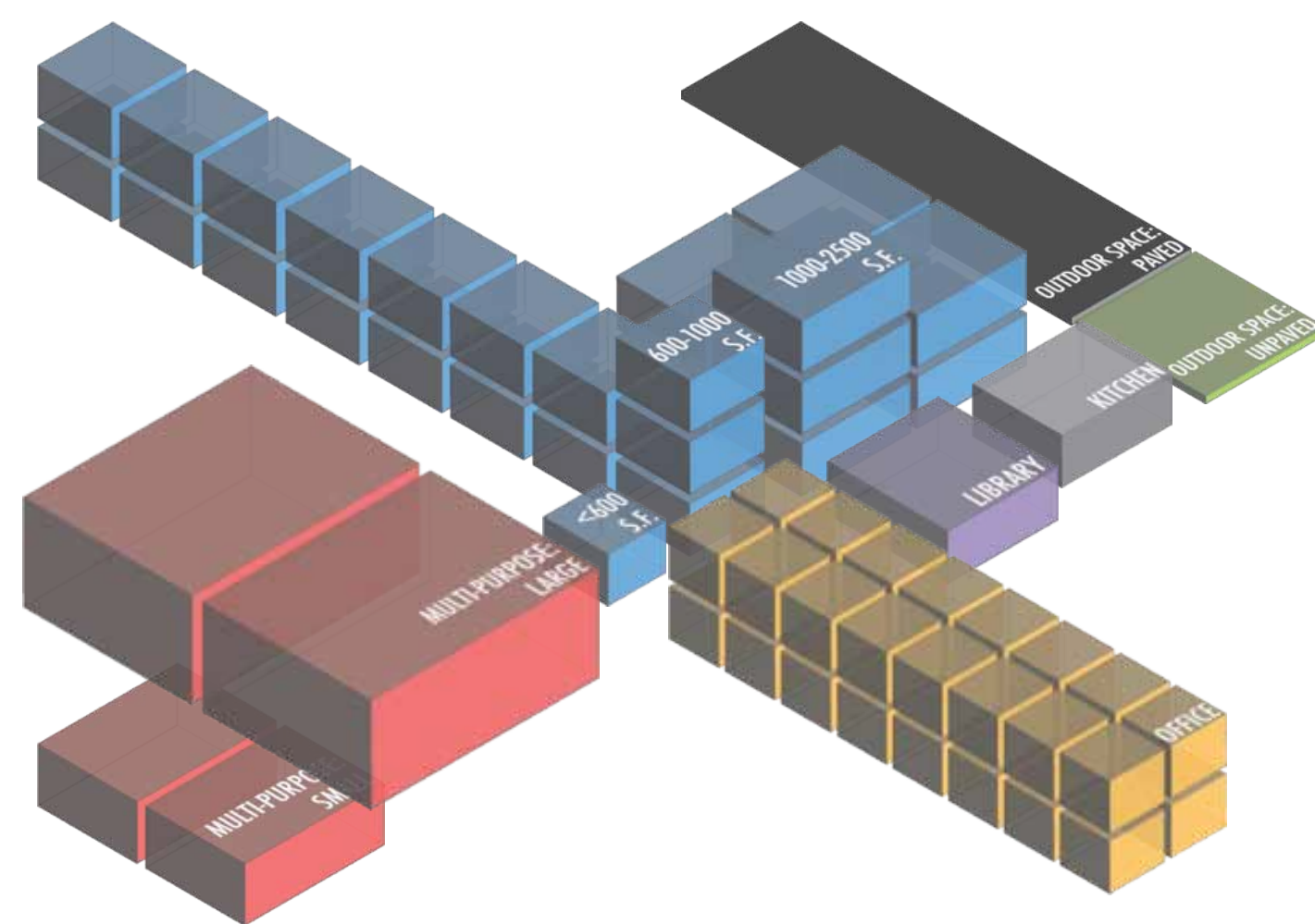

Summary Counts

	Total	Permanent	Portable
Site Acreage	14.4		
Building Footprint (sf)	79,362		
Building Area (sf)	85,599	83,157	2,442
Classroom-Sized Rooms	26	23	3
<i>1 room < 600 s.f. used as classroom</i>			
	Number of Rooms		Sq Ft
Library Rooms	1		1,971
Auditorium/Cafeteria/ Multi-purpose/Gym	4		12,913
Admin/Office/ Conference Room	32		5,659
School Gardens	Number: 1		Sq Ft: 140
Kitchen	Type: Finishing		
On-site Health Clinic	Yes		

SITE SUMMARY (Summer 2012)

Sports / Recreation

- Play structure
- Basketball hoops **12**
- Swimming pool
- Soccer/football field
- Volleyball court
- Track
- Baseball field
- Tennis court

Qualitative Assessment

Transit Accommodations

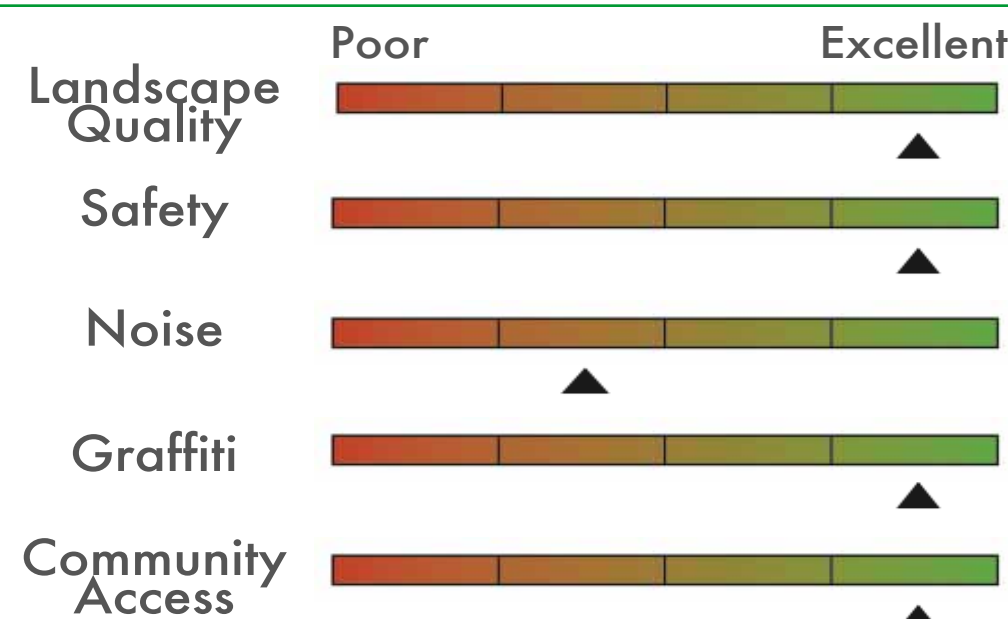

Open Space

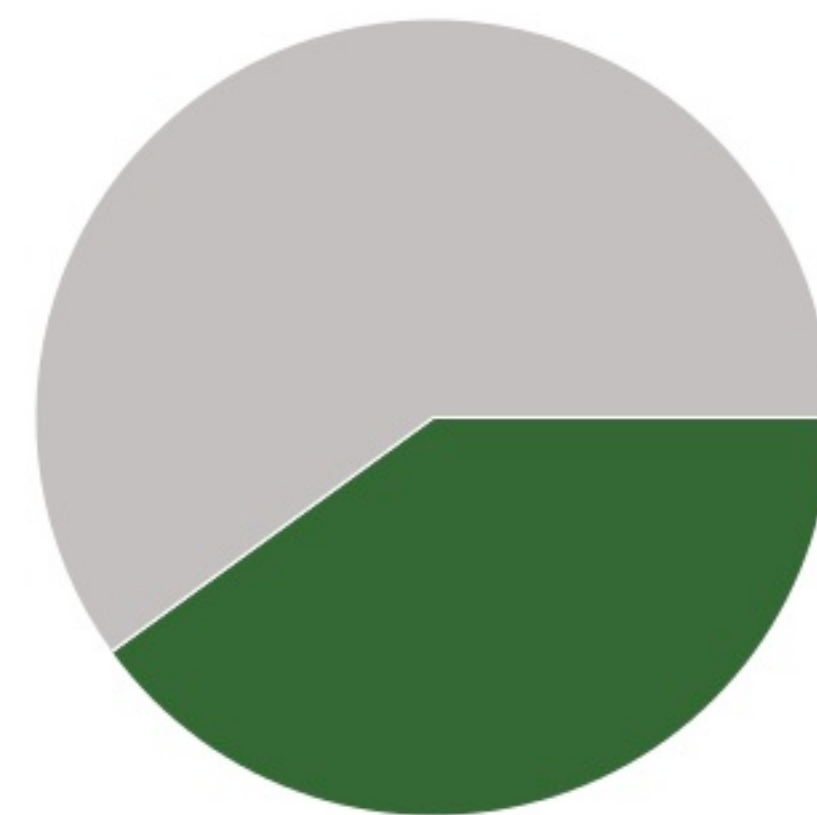

Paved 60% 40% Green

Madison Middle School

Building Records

Site ID 215

Region 3

Grades 6-8

Site & Facilities Photos - Summer 2011 (Sample)

*To view the full set, visit: <http://bitly.com/vYGnmm>

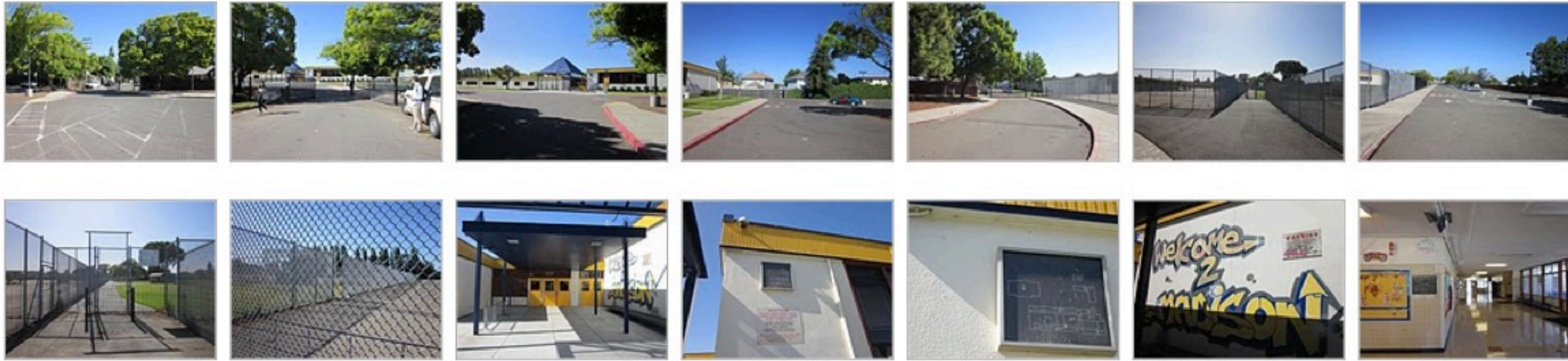

BUILDING A

BUILDING AREA (SQFT): 34,365

CONSTRUCTED: 1958

STRUCTURAL ELEMENTS

ROOFING

Plywood on wood joists and glulam beams

FOUNDATION

Strip footings (under structural walls)

VERTICAL RESISTANCE

Shear wall - Wood stud walls

QUALITATIVE BUILDING ASSESSMENT

EXTERIOR

Physical Condition



Circulation & Wayfinding



INTERIOR

Physical Condition



Circulation & Wayfinding



ROOM SUMMARY

NO. OF CLASSROOMS

12

NO. OF OFFICES

13

NO. OF ADMIN ROOMS

16

NO. OF RESTROOMS

7

NO. OF STUDENT COMPUTERS

15

NO. OF ADMIN WORKSTATIONS

24

ADDITIONAL ADMIN SPACES

Conference Room
Teachers' Lounge

BUILDING B

BUILDING AREA (SQFT): 25,279

CONSTRUCTED: 1958

QUALITATIVE BUILDING ASSESSMENT

EXTERIOR

Physical Condition



Circulation & Wayfinding

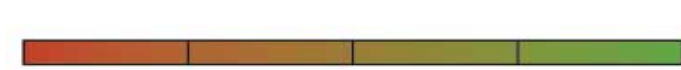

INTERIOR

Physical Condition



Circulation & Wayfinding

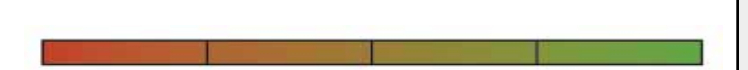

ROOM SUMMARY

NO. OF CLASSROOMS

4

NO. OF OFFICES

1

NO. OF ADMIN ROOMS

4

NO. OF RESTROOMS

4

NO. OF STUDENT COMPUTERS

3

NO. OF ADMIN WORKSTATIONS

1

ADDITIONAL ADMIN SPACES

Teachers' Lounge

BUILDING C

BUILDING AREA (SQFT): 6,943

CONSTRUCTED: 1958

STRUCTURAL ELEMENTS

ROOFING

Plywood on wood joists and glulam beams

FOUNDATION

Strip footings (under structural walls)

VERTICAL RESISTANCE

Shear wall - Wood stud walls

QUALITATIVE BUILDING ASSESSMENT

EXTERIOR

Physical Condition



Circulation & Wayfinding

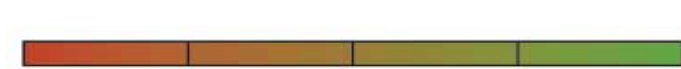

INTERIOR

Physical Condition



Circulation & Wayfinding

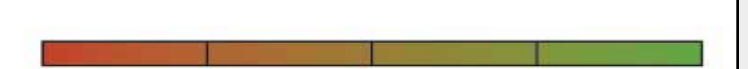

ROOM SUMMARY

NO. OF CLASSROOMS

3

NO. OF OFFICES

6

NO. OF ADMIN ROOMS

12

NO. OF RESTROOMS

4

NO. OF STUDENT COMPUTERS

2

NO. OF ADMIN WORKSTATIONS

10

ADDITIONAL ADMIN SPACES

Conference Room

BUILDING**D**

BUILDING AREA (SQFT): 16,570

CONSTRUCTED: 1958

STRUCTURAL ELEMENTS

ROOFING

Plywood on wood joists and glulam beams

FOUNDATION

Spread (under col.) & Strip (under struct. walls) footings

VERTICAL RESISTANCE

Shear wall - Wood stud walls/ Precast concrete panels

QUALITATIVE BUILDING ASSESSMENT**EXTERIOR**

Physical Condition

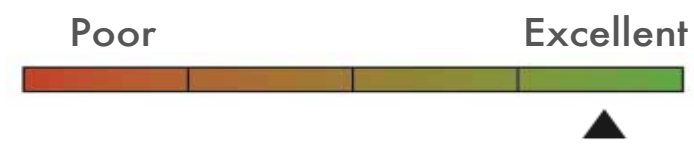

Circulation & Wayfinding

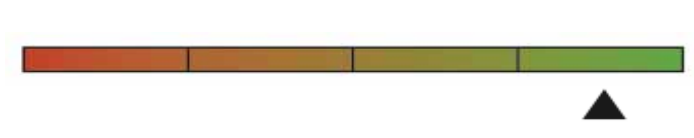
**INTERIOR**

Physical Condition

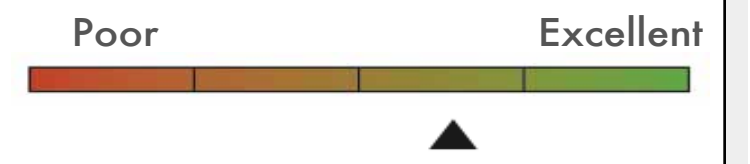

Circulation & Wayfinding

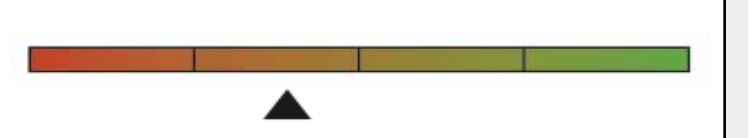
**ROOM SUMMARY**

NO. OF CLASSROOMS

NO. OF OFFICES

NO. OF ADMIN ROOMS

NO. OF RESTROOMS

2

2

8

NO. OF STUDENT COMPUTERS

NO. OF ADMIN WORKSTATIONS

ADDITIONAL ADMIN SPACES

2

Madison Middle School

Portable Records

Site ID 215

Region 3

Grades 6-8

	Manufactured:	<u>NO. OF CLASSROOMS</u>	<u>NO. OF ADMIN ROOMS</u>
P1	2001	1	
P2	1997	1	
P3	1997	1	

Portable Inventory

Total Count
3

Average Age
14 Years

Qualitative Conditions Assessment

	Poor	Excellent
EXT.		
INT.		

Madison Middle School

Rooms Summary & List

Site ID 215

Region 3

Grades 6-8

BUILDING	BLDG LEVEL	ROOM #	ROOM USE	ROOM AREA (SQUARE FOOTAGE)	CLASSROOM COMPUTERS	ADMIN WORKSTATIONS	MARKED ROOM #	ROOM CAPACITY
A	1	n/a	Building Utilities	112				
	1	n/a	Building Utilities	77				
	1	n/a	Building Utilities	243				
	1	n/a	Circulation	93				
	1	n/a	Circulation	72				
	1	n/a	Circulation	72				
	1	n/a	Circulation	96				
	1	um1	Storage	375				
	1	1	Classroom	1,008	1			
	1	um2	Building Utilities	625				
	1	2	Classroom	1,017	2			
	1	3	Classroom	802				
	1	um3	Admin/Office	256		1		
	1	a3	Storage	100				
	1	um4	Building Utilities	215			3	
	1	a4	Storage	100				
	1	4	Classroom	815	2			
	1	5	Classroom	831				
	1	6	Classroom	1,388	1			
	1	8	Classroom	825				
	1	a8	Storage	100				
	1	9	Classroom	831	1			
	1	a9	Storage	100				
	1	10	Classroom	815	4			
	1	11	Classroom	808	4			
	1	12	Classroom	808				
	1	13	Classroom	808				
	1	13a	Admin/Office	456			2	
	1	14	Lounge/Staff Dining	810			2	
	1	15	Storage	683				
	1	a19	Lounge/Staff Dining	271				
	1	a20	Restroom	79				
	1	a21	Restroom	99				
	1	a22	Lounge/Staff Dining	360				
	1	a23	Restroom	87				
	1	a25	Storage	413				
	1	a29	Restroom	206				
	1	a30	Restroom	239				
	1	a32	Storage	761				
	1	a33	Storage	154			1	
	1	a34	Admin/Office	184			1	
	1	a35	Admin/Office	200				
	1	a36	Library	1,971	32			
	1	b37	Building Utilities	531				
	1	a38	Building Utilities	29				
	1	a39	Restroom	209				
	1	a40	Building Utilities	109				
	1	a41	Restroom	224				
	1	b42	Admin/Office	93			1	
1	b43	Admin/Office	88			1		
1	b44	Admin/Office	88			1		
1	b45	Admin/Office	88			1		
1	b46	Admin/Office	99			1		
1	b47b	Storage	33					
1	b47a	Admin/Office	110			1		
1	b48	Circulation	346					
1	b49	Admin/Office	83					

	BLDG LEVEL	ROOM #	ROOM USE	ROOM AREA (SQUARE FOOTAGE)	CLASSROOM COMPUTERS	ADMIN WORKSTATIONS	MARKED ROOM #	ROOM CAPACITY
	1	b50	Conference Room	416				
	1	b51	Admin/Office	477		2		
	1	b52	Admin/Office	342		4		
	1	b53	Admin/Office	127				
	1	b54	Admin/Office	173		1		
	1	b55	Admin/Office	120		1		
	1	a58	Circulation	8,258				
BUILDING								
B								
	1	n/a	Circulation	96				
	1	um1	Restroom	18				
	1	um2	Locker Rooms	38			19	
	1	b3	Storage	156				
	1	um3	Building Utilities	18				
	1	b5	Storage	76				
	1	b6	Storage	252		1		
	1	b9	Storage	68				
	1	b10	Storage	217				
	1	b11	Multipurpose	984				
	1	b12	Multipurpose	3,962				450
	1	b13	Restroom	119				
	1	b14	Restroom	91				
	1	b14	Restroom	71				
	1	b15	Building Utilities	34				
	1	b16	Storage	104				
	1	b17	Building Utilities	182				
	1	b18	Circulation	136				
	1	b20	Storage	130				
	1	21	Classroom	1,447	1			
	1	b21	Building Utilities	807				
	1	22	Classroom	1,437	2			
	1	b22	Lounge/Staff Dining	725				
	1	b23	Circulation	2,421				
	1	23	Classroom	966				
	1	24	Classroom	1,430				
	1	b24	Storage	295				
	1	b25	Storage	55				
BUILDING								
C								
	1	n/a	Circulation	76				
	1	c4	Restroom	57				
	1	c5	Restroom	97				
	1	c6	Building Utilities	122				
	1	c7	Storage	161				
	1	c8	Classroom	311				
	1	c9	Storage	98				
	1	c10	Building Utilities	72				
	1	c11	Storage	92				
	1	c12	Storage	350				
	1	25	Classroom	1,374				
	1	28	Classroom	1,824				
	1	29	Classroom	1,066	2			
	1	100	Admin/Office	246				
	1	101	Admin/Office	240				
	1	102	Admin/Office	162		2		
	1	103	Circulation	340				
	1	104	Admin/Office	96		1		
	1	105	Conference Room	156				
	1	106	Admin/Office	94				
	1	107	Restroom	72				
	1	108	Admin/Office	76				
	1	109	Admin/Office	96				
	1	110	Admin/Office	96				

	BLDG LEVEL	ROOM #	ROOM USE	ROOM AREA (SQUARE FOOTAGE)	CLASSROOM COMPUTERS	ADMIN WORKSTATIONS	MARKED ROOM #	ROOM CAPACITY
	1	111	Admin/Office	130		3		
	1	112	Restroom	61				
	1	113	Admin/Office	206		2		
	1	114	Admin/Office	76		1		
	1	115	Admin/Office	72		1		
	1	116	Storage	23				
BUILDING								
D								
	1	1	Restroom	565				
	1	2	Locker Rooms	1,481				
	1	3	Locker Rooms	131				
	1	4	Locker Rooms	200				
	1	5	Storage	102			328	
	1	6	Building Utilities	63				
	1	7	Restroom	158				
	1	8	Storage	157				
	1	9	Restroom	52				
	1	10	Circulation	98				
	1	11	Admin/Office	244		1		
	1	12	Circulation	316				
	1	13	Locker Rooms	1,335				
	1	14	Storage	136				
	1	15	Storage	170				
	1	16	Storage	15				
	1	17	Restroom	73				
	1	18	Admin/Office	269		1		
	1	19	Circulation	420				
	1	20	Restroom	178				
	1	21	Building Utilities	13			309	
	1	22	Restroom	849				
	1	23	Storage	108				
	1	24	Circulation	266				
	1	25	Storage	33				
	1	26	Building Utilities	208				
	1	27	Storage	115				
	1	28	Restroom	70				
	1	29	Restroom	70				
	1	30	Storage	316				
	1	31	Gym	1,476				
	1	32	Circulation	266				
	1	33	Gym	6,491				
	1	34	Circulation	63				
	1	35	Circulation	63				
PORTABLE								
P1								
		1	Classroom	814	5			
PORTABLE								
P2								
		1	Classroom	814				
PORTABLE								
P3								
		1	Classroom	814	1			